

Sonoma State University

Master Plan Enrollment: 10,000 FTE

Master Plan approved by the Board of Trustees: April 1962

Master Plan Revision approved by the Board of Trustees: March 1967, October 1969, July 1970, January 1976, February 1980, May 1990, March 1992, May 2000, January 2021

1. Adlai E. Stevenson Hall (Classroom/Office)	49. PreCollege Programs
2. Darwin Hall (Science)	50. Donald and Maureen Green Music Center
3. Field House	50A. Music/Faculty Office Building
4. Charles Ives Hall (Music)	51. Restaurant/Meeting Facility
5. Physical Education	52. Joan & Sanford I. Weill Lawn and Commons
6. Ruben Salazar Hall	52A. <i>MasterCard Pavilion</i>
7. Student Health Center	53. <i>Parking Structure</i>
8. Rachel Carson Hall	60A. Beaujolais - Alsace
9. Ambrose Nichols Hall (Classroom/Office)	60B. Beaujolais - Bordeaux
10. Plant Operations Office	60C. Beaujolais - Classico
11. Corporation Yard	60D. Beaujolais - Loire
12. Boiler Plant	60E. Beaujolais - Madeira
13. Wastewater Equalization Tank Structure	60F. Beaujolais - Medoc
14. Corporation Yard Support Services	60G. Beaujolais - Domaine Meeting Room
16. Wine Spectator Learning Center	60H. Beaujolais - Office Pool
17. CAPS and Classroom Modularity	61A. Sauvignon - Alicante
18. International Hall	61B. Sauvignon - Burgundy
19. Art Building	61C. Sauvignon - Colombar
20. Pump House	61D. Sauvignon - Fume Blanc
21. Pump House-Fire	61E. Sauvignon -Grenache
22. Corporation Yard Warehouse	61F. Sauvignon - Marsanne
23. Physical Education/Storage Building	61G. Sauvignon -Sirah
24. Child Care Center	61H. Sauvignon - Barrel Room
25. Athletic Field Facility	61J. Sauvignon - Cooperage
26. <i>Not Used</i>	61K. Sauvignon - Cellars
27. Evert B. Person Theatre	62A. Verdot - Chablis
28. Aquatic Facility	62B. Verdot - Chenin Blanc
29. Anthropological Studies Center	62C. Verdot - Claret
30. <i>Instructional Expansion</i>	62D. Verdot - Meritage
31. <i>Professional Schools Building</i>	62E. Verdot - Sauterne
32. Jean and Charles Schulz Information Center	62F. Verdot - Sangiovese
33. <i>Instructional Expansion</i>	62G. Verdot - Chateau
34. Parking and Information Booth	62H. Verdot - Housing Maintenance
35A. Recreation Center	62J. Verdot - Linen and Custodial Warehouse
35B. Student Center	62K. Verdot - Landscaping Storage
36. Public Safety Building	62L. Verdot - Conference Events Services Storage
37. <i>Physical Education Addition</i>	63A. Cabernet - Gamay
38A. Tuscany - Mosel	63B. Cabernet - Merlot
38B. Tuscany - Piemonte	63C. Cabernet - Muscat
38C. Tuscany - Provence	63D. Cabernet - Pinot
38D. Tuscany - Rioja	63E. Cabernet - Tokay
38E. Tuscany - Rhone	63F. Cabernet - Carneros
38F. Tuscany - Savoie	63G. Cabernet - GReen Valley
38G. Tuscany - Trentino	63H. Cabernet - Viognier
38H. Tuscany - Veneto	63J. Cabernet - Chalk Hill
38J. Tuscany - Casentino	64A-C. <i>Residence Hall Phase I</i>
39. Greenhouses	64D-F. <i>Residence Hall Phase II</i>
40. <i>Art Building Addition</i>	
41. Recycle Plant	
42. Stadium	
43. Baseball Field	
44. <i>Soccer Stadium</i>	
45. <i>Not Used</i>	
46. Environmental Technology Center - ETC	
47. Campus Storage Building	
48. Gordon Smith Training Facility	

LEGEND:
Existing Facility / Proposed Facility

NOTE: Existing building numbers correspond with building numbers in the Space and Facilities Data Base (SFDB)

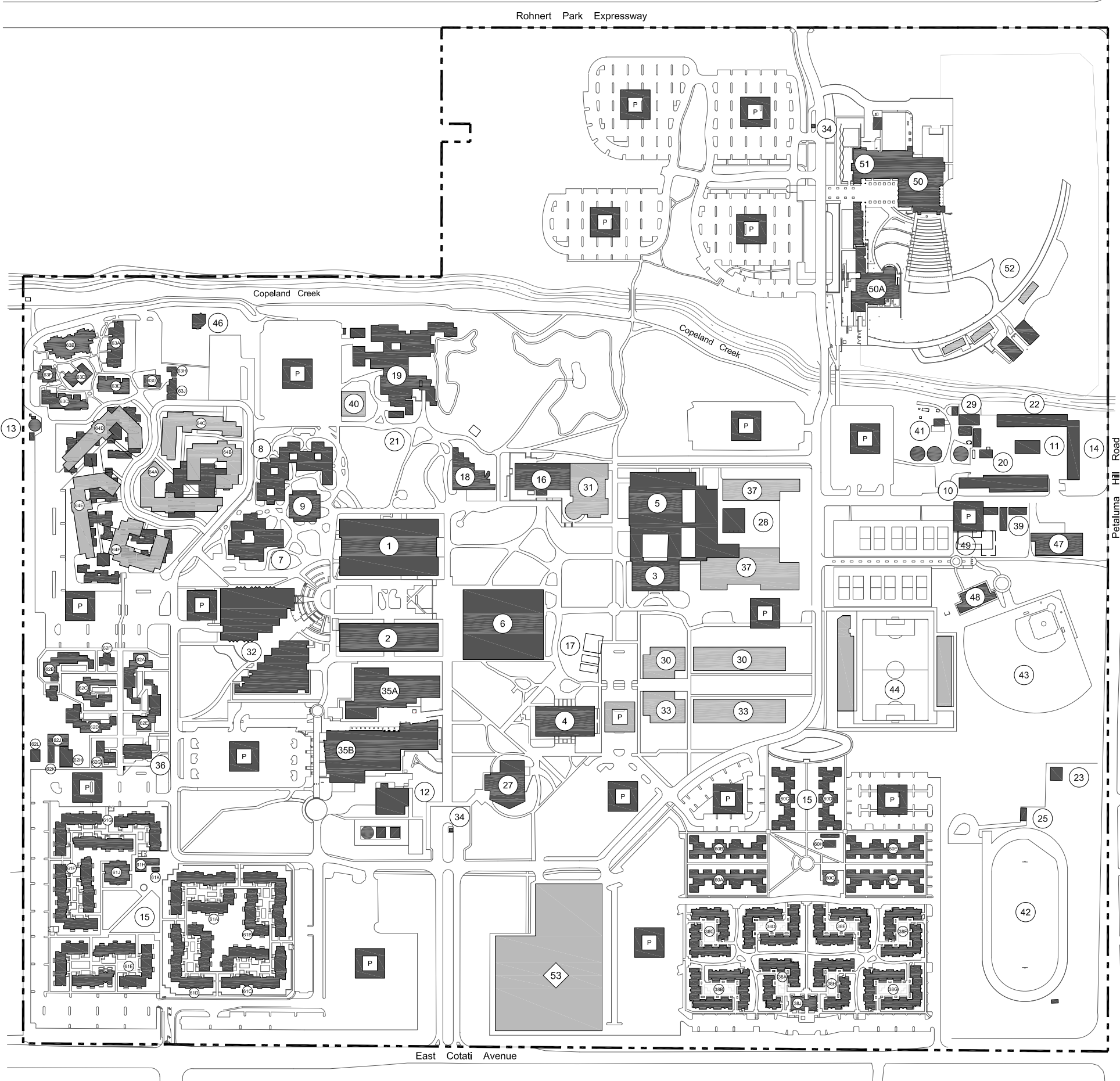

Sonoma State University

Campus Master Plan
 Master Plan Enrollment: 10,000 FTE
 Approval Date: April 1962
 Revised Date: January 2021
 Main Campus Acreage: 269

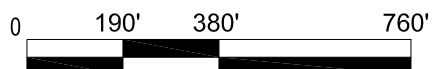
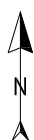

Buildings	Campus Boundary	Parking
EXISTING BUILDING	EXISTING	EXISTING LOT
FUTURE BUILDING	FUTURE	FUTURE LOT
TEMPORARY BUILDING		EXISTING STRUCTURE
EXISTING BUILDING NOT IN USE		FUTURE STRUCTURE